

This community newsletter is sent out monthly on behalf of tawalink.com, Tawa's community website since 2002.

Other sources of online community information in Tawa:

www.neighbourly.co.nz • www.facebook.com/VibrantTawa • www.facebook.com/tawacommunityboard

“SPRING INTO TAWA” LATER THIS MONTH

Saturday 27 October, 10am to 3pm, Main Road shopping area.

It's not long now until Spring into Tawa 2018. This year the event will be bigger and better than ever. We will have over 150 stalls including a wide range of Tawa groups and organisations, some of Wellington's favourite food trucks and a wide range of amazing crafts and products. There will be entertainment on the main stage all day including dance groups from Tracey Odell Dance School, Hayley Johnson Dance School, AMDC and La Zumba Loca, the Tawa Intermediate Kapa Haka and Pasifika groups.



This year we will also have a children's zone with activities and entertainment – all free of charge. This will include bouncy castle and giant games, face painting, balloon twisting and entertainment from Moana, Spiderman, Fairy Trina, Zane and Degge and the Bigger Bigger Bubble Show.



A reminder that the Main Road will be closed between the roundabout on the corner with Cambridge Street, and the roundabout on the corner with Surrey Street all day on Saturday 27th. A detour will be operating.

We're still looking for volunteers to help us on the day – if you can spare an hour or two, please let us know by emailing spring.into.tawa@gmail.com

Stay tuned to our Facebook page for competitions and updates on the event. Make sure you mark it in your diary and come down for what promises to be an awesome day.

VOTING TO SUPPORT A COMMUNITY GROUP

You've voted and we [the Spring into Tawa organising committee] have heard! We asked you which local organisation we should support with any surplus funds from the event. We had a huge 119 votes – and the clear preference was the Tawa Youth and Families Trust with 51 votes. MenzShed was next, followed by Tawa Community Patrol. Congratulations Tawa Youth and Families Trust!

We're thinking about ways we can support the other two great organisations at the event – more on that later.

THE TAWA PLAZA UPGRADE HAS BEGUN

As per the WCC website: “The purpose of the Tawa town centre improvement project is to make the centre a more attractive, vibrant, and safe place.

The upgrade of Tawa Plaza will take place from October 2018 to early 2019. The changes include new planting, street furniture, bright pavements and lighting. The improvements will connect the plaza with the shopping district and create a gathering space for community events. The work will be noisy at times but the shops in the plaza will remain open. It’s the final phase of our Tawa town centre upgrade.”

Last week a specialist landscape crew lifted the plants in the temporary garden bed and took them to a nursery to be looked after. These plants will be replanted in the new garden beds that will be created. All existing trees in the plaza will remain.

The furniture, lights and drainage elements have been procured over the past couple of months as these had long lead timeframes.

The contractors will be downing tools for “Spring into Tawa” on 27 October and again for Christmas and New Year’s. Council will work closely with the festival organisers and businesses to minimise construction disruption as much as possible.

See more information at <https://wellington.govt.nz/your-council/projects/tawa-town-centre-improvement-project>

Last Friday morning a karakia was held on site led by Taku Parai (Ngāti Toa) to bless the site and the ground beneath as the project moves into the construction phase. The second photo above features some of the 16 people – contractors, landscape architects, councillors, etc – involved at the karakia.



L to R: Councillor Jill Day, Tawa Community Board chair Richard Herbert, Crs Malcolm Sparrow & Peter Gilberd.

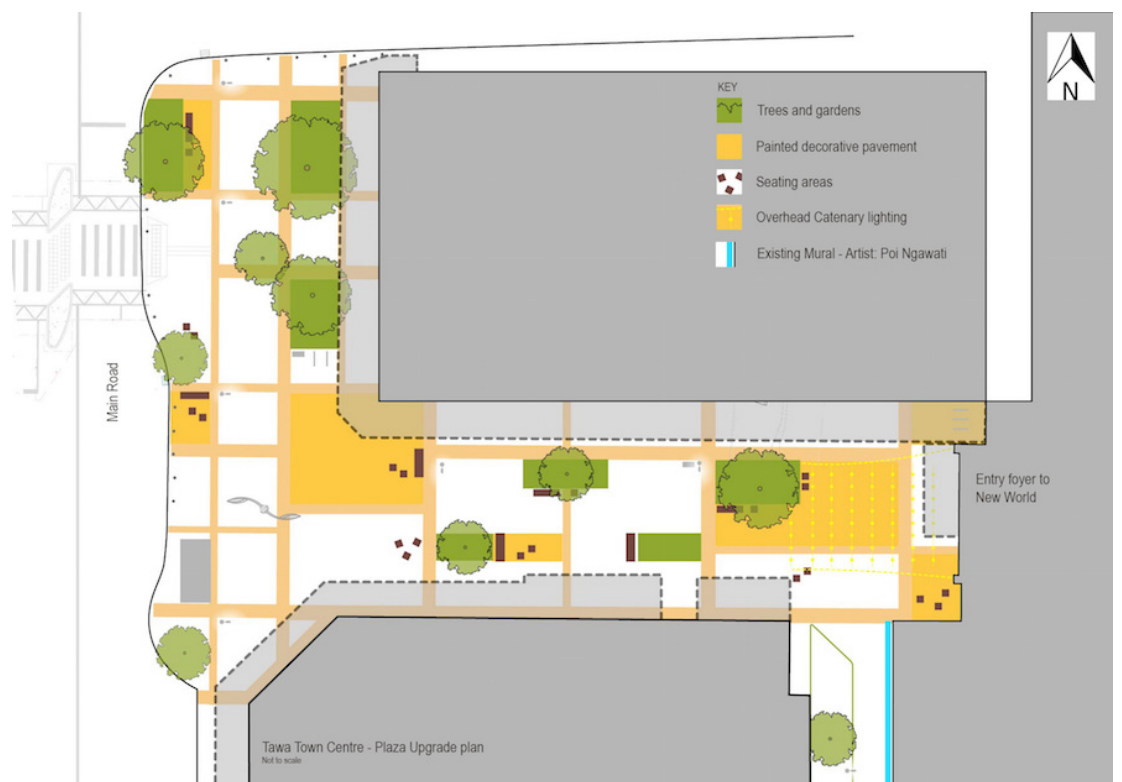

ARTWORK ON DISPLAY DURING “SPRING INTO TAWA”

When you're at Spring into Tawa on Saturday 27 October, make sure you pop into the Tawa Community Centre in Cambridge St to see the U3A/Community Centre Art Group – the “Tawa Arties” display. It's free, there won't be any for sale, but you can enjoy their talent on display!

CAN YOU ASSIST AT THE REDWOOD CLUB?

The Redwood Club is a specialised professional day support and care facility for the older person and is located at 83 Redwood Ave in Tawa.

Currently we are short of volunteers on weekday mornings. Hours are 9.30am-1pm. Duties include: serving morning tea, setting up tables for lunch, assisting staff serving lunch to our members and helping with dishes afterwards.

If you are interested in becoming a volunteer at our very special club either on a permanent or casual basis, we would be delighted to hear from you. Please contact Wendy at the Club phone 232 5521.

TAWA RSA COMMUNITY BOWLS

Tawa RSA is running its Community Bowls programme again this summer. It is open to all members of the community. Several new teams came aboard last summer and appeared to enjoy themselves.

We invite you to take part by way of a work, family or community team. The format is four members to a team. Our venue is at 89 Oxford Street, Tawa.



There is a \$20.00 entry fee per team (\$5.00 per player) payable each game.

We play this as a league. Play each evening is one game, starting 6.00pm and finishing at 7.20pm. Sausage sizzle is served at 7.25pm.

Scheduled dates are (all on Wednesdays):

24 October, 7 & 21 November, 5 December, 23 & 30 January, 20 February, 6 & 20 March.

To register a team, or for more info, please contact prior to mid October:

Graham Allnutt @ 232 4056 or 027 339 6667 OR Alastair Miller @ 027 486 2880.

New Zealand
**Shake
Out**™ 



Our national earthquake drill and tsunami hīkoi
9:30am, 18 October 2018

BANNER FLAGS IN TAWA

The Tawa Business Group has commissioned the installation of banners and flags along the Main Road in Tawa. Banners are being located in clusters of 2-3 flags at numerous locations between Linden and Takapu Road, with the hardware for flags to be installed throughout the Town Centre.

Wellington City Council has generously contributed \$17,000 towards this project, with Tawa Business Group allocating \$25,000 from this year's budget to cover the balance. TBG is excited about the impact the flags, featuring the new Tawa logo, will have. The real 'flagship' will be installed in time for Spring into Tawa at the end of the month.



EDUCARE TAWA

Educare Tawa is Educare's newest early learning centre. Located at Tawa Junction, we are now open and enrolling tamariki. We welcome centre visits!



For those of you who haven't seen us already, we are right next door to Big Air at 10 Surrey Street, Tawa Junction. You are welcome to come and say hello. You will be shown around by one of our friendly staff. We are open 7.30am to 5.30pm. See <http://www.educare.co.nz/educare-centres/tawa/>

HOP In

= Holiday DrOP In



Holiday Fun for Care-givers and Pre-schoolers

An opportunity for adult company while your pre-schooler plays in a safe environment

Plenty of toys and activities!

Morning tea available

Everybody is welcome!

Join us on

Thursdays 04 and 11 October 2018
10am - 12 noon
At Tawa Union Church, Elena Place

Your donations of cash for the Cannons Creek Food Bank will be appreciated

Enquiries to the Church Office 232 8844

WHAT ARE PEOPLE DOING TO OUR PLANET?

ECOLOGY AND FAITH - a U3A series of talks



THREE LECTURES at 10am at Tawa Union Church
FOLLOWED BY QUESTIONS AND DISCUSSION
(Tea/coffee etc at 9.30 am)

- Monday 1 Oct. Prof. Martin Manning
"Ecology, Revolution and Theology"
- Monday 8 Oct. Rev. Dr. Betsan Martin
"What's ahead for climate change?"
- Monday 15 Oct. Ms Catherine Gibbs
"We are all connected" (ecothology)

Co-ordinator - Ron Bichan (2326185) ronbichan@gmail.com

SENIORS' WEEK NEXT WEEK

Monday 15 to Sunday 21 October 2018.

Seniors' Week is held in October every year and involves events for senior citizens and the elderly right across Wellington. For details of what's happening in other parts of the city, see <https://wellington.govt.nz/events/annual-events/seniors-week>

In Tawa you're invited to a morning tea at the Tawa Community Centre 10.00am-11.00am on Friday 19 October. Join the Tawa Community Centre regular U3A Scrapbook group in testing your knowledge with the daily newspaper quiz.

For more information, phone Mandy Russell on 232 1682 or email mandy.russell@wcc.govt.nz.

Bring a friend if you would like to. Meet some like-minded folk. You will feel so much better having joined in!



TAWA'S UNSUNG RUBBISH CRUSADER

*The DomPost has lately been running various articles on litter and the people who go out of their way to keep their part of Wellington litter-free. We suggested they look at the great job Peter Turney does in keeping the streets of Tawa clean. He has received more than one **Tawa Community Civic Award** for his voluntary contribution locally. The following article and photo appeared on 'Stuff' recently.*

Tawa resident Peter Turney has been picking up rubbish in Tawa for about 10 years. He started cleaning up leaves and branches around the street in 2008, but noticed that rubbish was tied up in it.

Turney said he decided to make collecting litter part of his weekly routine, and now he walks for about four hours, several times a week to collect litter. "I've almost made it my job."

Turney sets out early in the morning with plastic bags from the council tied to his belt, and he aims to finish with at least two full bags. "I have an unwritten agreement that if I leave the bags by a particular litter box, they [the council] know it's me, and they'll take it to the landfill for me."

As a Christian, he felt it was his duty to protect the environment, and the four-hour walk kept him fit. "It saves me gym fees."

People would often stop to say hello, he said. "I find it very encouraging. Particularly when I am feeling tired, when they say things like that to me it gives me a new burst of energy."



TAWA TABLE TENNIS CLUB

The Tawa Table Tennis club has concluded for 2018 but will start up again at Porirua East School, the most likely date being Tuesday, 9 April 2019. This will be confirmed in the New Year once the school is up and running again and can confirm that Tuesday is still available for us.



TAWA COMMUNITY LIAISON GROUP MEETING

The next meeting of the Tawa Community Liaison Group is at 12 midday on Monday 15 October in the boardroom at the Tawa Community Centre. These meetings, which take place for not more than an hour every six weeks, provide an opportunity for representatives from community groups, businesses, schools, churches, Tawa Community Board members, etc, to catch up on what's happening in the wider Tawa community, as well as to 'network'.

For more info, contact Mandy on 232 1682 or mandy.russell@wcc.govt.nz

TAWA STAKEHOLDERS RESILIENCE MEETING

The next twice-yearly meeting of the Tawa Community Liaison Group is at 7pm on Thursday 25 October in the boardroom at the Tawa Community Centre. This is for those who have an interest in "emergency preparedness" matters in Tawa.

For more info, contact Tawa Community Board deputy chair Marg Lucas on mm.lucas@xtra.co.nz

2018 TAWA COMMUNITY CHRISTMAS PARADE



This year's Tawa Christmas Parade is scheduled for 2pm on Saturday 1 December. The Christmas Parade has been an annual event in Tawa for over 20 years. Its ongoing success always depends on the participation of the many Tawa organisations who continue to support it. Tawa Lions will continue to organise the event but we need YOU to participate with us.

If your club, group or organisation wants more information or wishes to commit to this year's Tawa Christmas Parade, please contact Mike on 232 6406, email tawawlions@lionsclubs.org.nz or visit our website <http://www.lionsclubs.org.nz/Clubs/202M/Zone-6/Tawa>

TAWA COMMUNITY CHRISTMAS CAROLS

Saturday 1st December from 4.30pm till 8.00pm.

Live music and Christmas songs to be sung – Prizes & Santa – Sausage sizzle and Fundraising from Tawa H & S – Entertainment.

Bring a picnic and enjoy a festive evening on the Tawa School sports field.



- FUN
- FOOD
- MUSIC
- GAMES
- TALENT QUEST

Wednesday 31st OCT 2018

TAWA NEW LIFE CHURCH –236 Main Rd

6pm–8pm (sausage sizzle for tea, vegetarian option)

AGES 5-12 years

THEME - COME JOIN THE

CIRCUS

NO HALLOWEEN COSTUMES PLEASE

This event is FREE But tickets are limited and essential for entry from:

Take Note Tawa (Postshop) Main Road Tawa

Or call Michele 2324924

**Absolutely
Positively
Wellington**
Me Heke Ki Pōneke





Christmas in the Atrium

This year the Inner Wheel Club of Tawa is hosting 'Christmas in the Atrium', an opportunity for community groups to raise their profile and gain some extra \$\$ to support their community services over the Christmas period.

What: There are nine tables available for organisations to purchase for the purpose of decorating with a Christmas theme which will be voted on by the public.

The tables are available for any community group in Tawa i.e. Salvation Army, Rotary, Lions, Church groups, Youth groups etc. The cost of the table will be the responsibility of the organisations but all advertising, promotions, flyers will be covered by the Inner Wheel Club of Tawa.

'Stars' will be available for children to colour-in for a donation of \$2 and added to the Christmas tree in the Atrium.

Individuals and Families can also purchase a Tag for \$5.00 and write a remembrance message for a loved one which can be hung on the tree. The proceeds will go towards the Salvation Army Christmas Appeal.

We are also seeking expressions of interest from community groups who may wish to provide some entertainment during the event e.g. music groups, choirs, school choirs.

The best table decoration will be chosen by the public and all the organisations get to keep all funds donated to them.

When: *Saturday December 1st 10-4pm* to coincide with the Lions Christmas Parade and the Christmas Festival. If you are an organisation sponsoring a table, then decorating would occur in the morning so that it was completed by 10am.

Where: Atrium at New World Supermarket, Tawa

Who: For further information please contact Carolyn Crutch at carolynjcrutch@gmail.com or on 232 1259

Register your interest through Provide name of organisation and contact details.

RESOURCE CONSENTS IN TAWA

If you're interested in perusing Tawa resource consent applications and approvals for the period 30 August to 27 September, see pages 9 & 10 of the Tawa Community Board's October agenda at: <https://wellington.govt.nz/~media/your-council/meetings/community-board/tawa-community-board/2018/10/tawa-community-board-agenda-october-11-2018.pdf>

TEMPORARY CLOSURE OF COLLINS AVE

We reported in last month's newsletter that Collins Ave was to be closed for a 12-hour period on a Saturday for the demolition of part of the old section of Collins Ave SH1 overbridge. The intention was for that to happen in late September. Various 'issues' mean that the closure has been delayed and a date has yet to be decided.

Once a firm date is set, full details of the timing and the diversion route will be published via social media channels, and letters will be delivered to nearby residents. VMS (electronic) boards will also be in place at appropriate spots to make people aware of the upcoming closure.

If you have any questions or concerns please call 0800 TGINFO (0800 844 636) or email the Transmission Gully team at info@tg.co.nz

TRACKS IN TAWA (map at right)

The following website shows all the walking tracks in and around Tawa: <http://tracks.org.nz/area/show/142>

Eric Raven who knows most things about Tawa – see “2 Minutes with Eric Raven” at <http://www.tawalink.com/2mins/tawanews-aug2018.pdf> – concedes that even he didn't know some of these tracks existed!



APARTMENTS BEING BUILT AT LONGVIEW REST HOME

When you're heading south on the Main Road and approaching the roundabout at Redwood Ave (south), look up on the hill in front of you and you'll see a lot of construction taking place.

As the real estate blurb states: “Work is currently under way on 28 one and two bedroom independent retirement apartments on the slopes surrounding Longview Rest Home.

Consisting of open plan living, modern kitchen, bathroom/ensuite these architecturally-designed apartments are being built to high modern standards with insulation, double glazing and air conditioning. Each apartment will have its own outdoor space with either a deck or patio.

Longview apartments will allow you to enjoy the company of people who are like-minded, giving you the opportunity to enjoy the freedom of your retirement years. Families can have 'Peace of Mind' that Mum and Dad are in a modern warm apartment.

A stunning communal recreational space will enable you to socialise with family and friends and enjoy the views across the valley.”

[End of blurb].

More details at <https://nz.raywhite.com/wellington-city/tawa/1962335/>



2 MINUTES WITH Amelia Kerr

Melie Kerr is in her last year at Tawa College, yet made her international debut for the New Zealand women's cricket team, the White Ferns, against Pakistan in November 2016.

She is probably the only current school student in Tawa with an entry in Wikipedia! This is some of that wording: "On 13 June 2018 Melie Kerr made the highest individual score in a Women's One Day International cricket match, and became the youngest cricketer, male or female, to score a double century in ODI cricket, when she scored 232 not out – a very appropriate Tawa number – against Ireland. The double century was also the third-highest individual score, male or female, in an ODI. Later in the same match she also took 5 wickets for 17 runs, her first five-wicket haul in WODIs."

Melie is very proud to be from Tawa. By the same token, Tawa is very proud to call Melie one of our own.



Where were you born? Wellington Hospital

Where did you grow up? In Tawa. I have lived here 17 years and think that it is an amazing place and has a great community.

Where were you educated?

Redwood primary, Tawa intermediate and I'm in my last year at Tawa College.

What subjects are you doing this year at college?

This year I'm taking physical education, psychology, English, foods and society and health.

What are you hoping to do when you leave school?

I will keep playing cricket but I am thinking about doing part-time uni in Wellington. I have always wanted to be a teacher so I will probably study education. I would also love to help kids out who have had tough upbringings and be a mentor for them.



What about family?

I have very strong family values and my family are the most important thing in the world to me. My Poppa Bruce Murray played for the Black Caps, and both my parents Robbie Kerr and Jo Murray played cricket for Wellington. My sister Jess also plays cricket for Wellington. I have a lot of cousins that all very sporty or musical [most on the Murray side of the family live in Tawa – Ed.] and we all get along great and I love spending time with them.

What are your interests and hobbies?

I love every sport. When I'm not playing cricket I enjoy a bit of social basketball. I'm very social and love spending time with my friends. I also really enjoy music and would love to learn an instrument when I have more time.

..... contd

contd

Favourite sports team [silly question really!] and/or sports person?

My favourite sports team has to be the White Ferns. I have always looked up to Bethany Hamilton, the surfer whose arm got bitten off by a shark.

Favourite musical group and/or individual singer?

My favourite singer is probably Ne-Yo [Wikipedia: an American singer, songwriter, record producer, actor and dancer – Ed.] and my favourite group is ABBA.

What is your favourite holiday destination in New Zealand?

I love Queenstown and all the adventure and adrenalin activities down there.

What accomplishments/achievements in your life (to date) give you the most satisfaction/pride?

I guess the game I got 232 was pretty special and an amazing day. Every time I play for New Zealand is something I am very grateful for. I don't really look back at my performances now but when I'm retired that's when I will probably recognise what I have done more. I love playing cricket and want to perform well but at the end of my career I would rather be remembered for being a good person and a great team player than that time I scored some runs.



What goal or goals do you have for the years ahead?

A World Cup is the pinnacle event for the White Ferns, so my goal would be to win a World Cup. I want to become a genuine all rounder for New Zealand and I would love to captain the side one day.



Put a spring in your step!

Ladies come along and have a go at our open evenings

Where: Redwood Club, 83 Redwood Ave, Tawa, Wellington 5028

When: Wednesdays 17, 24 and 31 October, and 7 November
7:30-9:00pm

We welcome women dancers (no experience necessary!) and musicians

"cheaper and more fun than the gym"

For more info contact whiterosemorris@gmail.com

Come dance a few steps, clash a few sticks and wave a few hankies



Gents, you're welcome too – practices with Britannic Bedlam
Morris Gentlemen, same Wednesdays 7:45pm at the Tawa
Pipe Band Hall beside Redwood Station